

# Manifold cabinet TT-VS-110T

Suitable for:

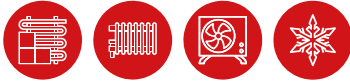

The TT-VS-110T is a flexible and robust flush-mounted manifold cabinet, ideal for the installation of underfloor manifolds for heating and cooling. With its high-quality construction and depth-adjustable components, it offers optimum adaptation to various installation requirements.

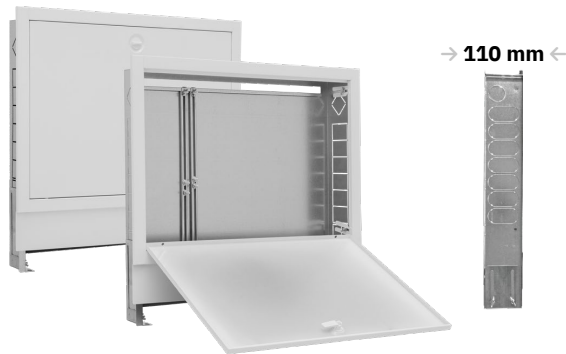

- **Installation frame:** Sheet steel, hot-dip galvanized.
- **Front:** 2-part (frame with plug-in door), depth-adjustable, white plastic-coated RAL 9016, with cabinet lock.
- **Installation depth:** Adjustable with stepless punching between 110 and 150 mm.
- **Screed plate:** Depth-adjustable and white plastic-coated.
- **Cabinet feet:** Reinforced, height-adjustable steel feet.

The delivery includes the cabinet with two manifold mounting rails and the front. Both components are packed separately so that the front can be stored safely until final assembly. The protective cardboard supplied protects the built-in contents during the construction phase.

	TT-VS 4/400	TT-VS 5/500	TT-VS 7/600	TT-VS 9/750	TT-VS 12/900	TT-VS 14/1050	TT-VS 17/1200	TT-VS 20/1500
<b>B = Width</b>	435 mm	490 mm	575 mm	725 mm	875 mm	1025 mm	1175 mm	1475 mm
<b>Height</b>	700 - 880 mm							
<b>Depth</b>	110 - 198 mm							
<b>F = Front</b>	460 mm	515 mm	600 mm	750 mm	900 mm	1050 mm	1200 mm	1500 mm
<b>G = Door</b>	395 mm	450 mm	535 mm	685 mm	835 mm	985 mm	1135 mm	1435 mm
<b>Niche in mm</b>	455 x 730	510 x 730	595 x 730	745 x 730	895 x 730	1045 x 730	1195 x 730	1495 x 730
<b>ORDER NO.</b>	4504	4505	4507	4509	4512	4514	4517	4520

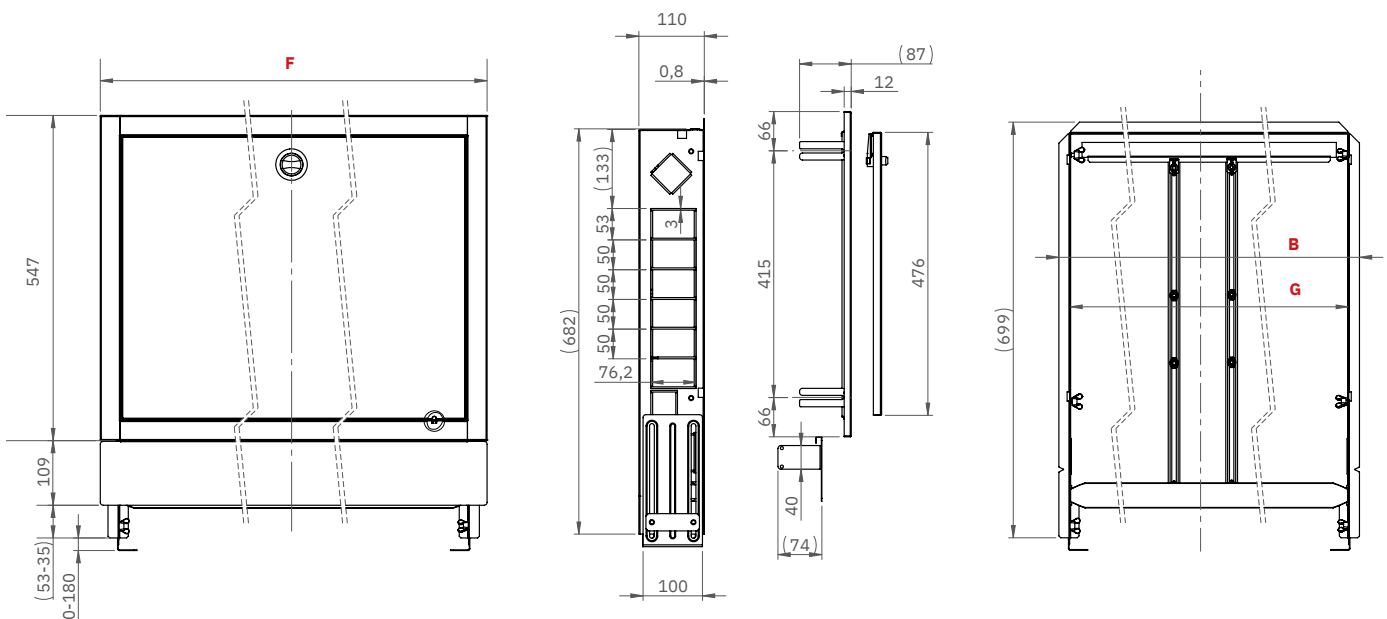

Other cabinet variants available on request.